

ENCLOSURE INSTRUCTION MANUAL



JBL

CONTENTS	Assembly	1
	Installing the Dividing Network	1
	Porting	2
	Installing the Loudspeaker Components	3
	Finishing the Enclosure	3
	Connecting the Loudspeakers	4
	Placement and Adjustment	4
	Care of Finish and Grille	5
	Service	5
	For Additional Information	5

ASSEMBLY

To assemble your JBL Loudspeaker Component system, you will need a Phillips-head screwdriver and white glue. If your system uses a two-piece dividing network, you will also need an electric drill and a sharp knife.

If you intend to use the optional blank, uncut baffle panel on your enclosure, you will need to cut mounting holes and a port, and, in some cases, fabricate a porting duct. Blueprints are included in the JBL Loudspeaker Construction Kit. You may be interested in the JBL MA15 Loudspeaker Mounting Kit, which simplifies mounting the low frequency loudspeaker; it is available from your JBL Loudspeaker Component dealer.

The enclosures are packed with fiberglass insulation to eliminate standing waves and internal reflections. Because fiberglass can irritate the skin, we recommend that you wear rubber gloves to protect your hands while installing the components.

Please read each procedure through at least once before attempting it. Loudspeaker mounting screws must be tightened evenly in several stages to avoid warping the frame, and only enough to prevent air leaks between the components and the enclosure. Avoid using excessive force.

There are three phases of assembly: installing the dividing network, porting, and installing and wiring the loudspeaker components. To begin, remove the enclosure from its shipping carton and place it upright on a clean, padded surface.

INSTALLING THE DIVIDING NETWORK—Two types of networks are used in the JBL Loudspeaker Component Series. The first type consists of a single, self-contained unit which mounts in a cutout in the rear panel. The other consists of two units connected by a cable: the main unit, which mounts on the inside rear panel, and a smaller control assembly, which mounts in or at a cutout in the rear panel.

All enclosures are shipped with the network mounting cutouts covered. Model EN3P has a terminal plate mounted in its single rear-panel cutout. Models EN5 and EN8 have two cutouts; a terminal plate is mounted in one and a blank cover plate in the other. To install a network which has its own terminals, remove the terminal plate from the rear panel of the enclosure and mount the

network in its place. To install a network which does not have its own terminals, remove the blank cover plate and mount the network in its place.

To install a one-piece dividing network, insert it from the outside into the appropriate mounting hole in the rear panel, making sure that the white vinyl gasket is between the mounting flange and the enclosure. Then insert and tighten the mounting screws.

To install a two-piece network, begin by removing the fiberglass insulation from the lower left rear corner of the back panel, using the mounting template as a pattern. To protect your skin, wear rubber gloves and long sleeves while cutting the fiberglass.

Drill through the rear panel of the enclosure, using the holes in the mounting template as a guide. Be sure to keep the drill perpendicular to the panel.

First install the control unit. There are two types of these: one mounted on a flat plate, the other in a metal housing. The flat plate unit mounts inside the rear panel and is secured by four screws. The housing must be passed through the cutout from the inside, then positioned correctly with the mounting gasket in place between the mounting flange and the panel, reinserted into the cutout, and secured with the mounting screws provided.

Place the main unit in the area from which the fiberglass has been removed, and holding it in place, insert and tighten the mounting screws.

PORTING—Porting ducts, if required, are supplied with all but the optional blank baffle panels. Uncut baffles will require lengths of 75-mm (3-in) outside diameter PVC pipe, which the user must supply. The EN5C 140-litre (5 cubic foot) enclosure has porting ducts mounted; ducts may be mounted permanently in the ports of the other enclosures with white glue.

EN3P 85-LITRE (3 CUBIC FOOT) ENCLOSURE—
124A: Mount the 100-mm (4-in)-long porting duct provided.

D123: Do not mount the porting duct.

LE10A or LE14A: Cut and mount a 100-mm (4-in) length of 75-mm (3-in) O.D. PVC pipe.*

EN5C 140-LITRE (5 CUBIC FOOT) ENCLOSURE—

D130 or 130A: Leave both ports uncovered.

LE15A: Cover port containing 100-mm (4-in) duct with the cover plate provided.

136A: Cover port containing 50-mm (2-in) duct with the cover plate provided.

EN8P OR EN8C 225-LITRE (8 CUBIC FOOT) ENCLOSURES—

LE15A: Mount 100-mm (4-in) ducts (supplied) in both ports.

D130 or 130A: Do not mount the ducts; leave both ports uncovered.

* For use with optional blank baffle.

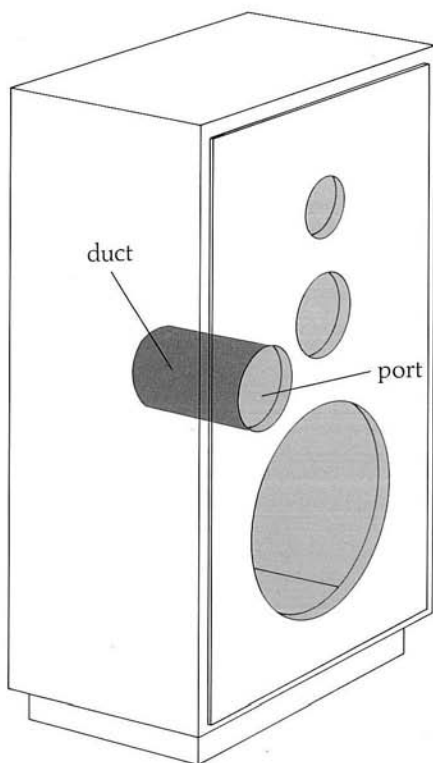

INSTALLING THE LOUDSPEAKER COMPONENTS—

Referring to the wiring diagram for your system (to be found in the JBL Loudspeaker Component Series Instruction Manual), first connect, then install, the loudspeaker components in order from the smallest to the largest. Mounting instructions may be found in the JBL Loudspeaker Component Series Instruction Manual.

CAUTION: If your system uses a compression driver/horn/lens assembly, remove the assembly whenever the system is to be transported; otherwise the unsupported compression driver may pull the horn free, damaging the baffle panel.

FINISHING THE ENCLOSURE

To finish your enclosure, you will need 180 and 220 grit sandpaper, a sanding block or an electric sander, and varnish, lacquer, or one of the several clear oil finishing preparations available from furniture or hardware stores.

Begin by sanding the entire surface of the veneer, using the sanding block or electric sander. Start with 180

grit paper and finish with 220, being careful not to sand through the veneer. Fill any flaws or holes in the veneer with wood putty and sand the putty level with the surface of the veneer.

For a lacquer or varnish finish, seal the veneer with a wood sealer, sand once more with 220 grit paper, and apply the lacquer or varnish according to the manufacturer's instructions.

For an oil finish like that found in JBL's production loudspeaker systems, cover the entire surface of the veneer with an oil finishing preparation. Allow the oil to sink into the veneer for fifteen minutes, wipe off the excess, and sand lightly with 220 grit paper. Repeat the procedure, but do not sand the second time. Rather, rub the surface with a clean, soft, dry cloth.

To connect loudspeaker systems placed up to 15 m (50 ft) from the amplifier, 1-mm (18 AWG) insulated wire (ordinary household lamp cord) is the minimum size recommended. For greater distances, heavier wire is desirable: 1.3-mm (16 AWG) for distances up to 30 m (100 ft) and 1.6-mm (14 AWG) for distances up to 60 m (200 ft).

Refer to the wiring diagrams in the Loudspeaker Component Series Instruction Manual for the correct connections to your loudspeaker system.

CONNECTING THE LOUDSPEAKERS

Cutout-Mounted Terminal Plate

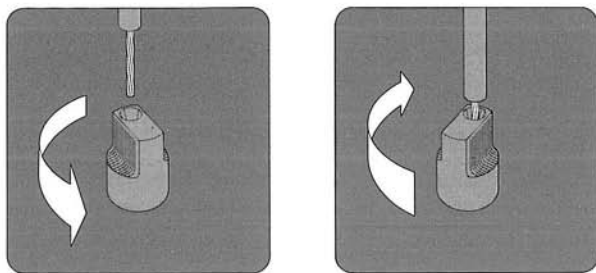

1. Strip approximately 20 mm ($\frac{3}{4}$ in) of the insulation from the end of the wire. Twist the wire strands together.
2. Turn the terminal fully counterclockwise, insert the wire, then turn the terminal clockwise until the wire is secured. Rotate the terminal by hand—do not force it.

For the best possible stereo performance, the two loudspeaker systems should be arranged symmetrically on either side of the listener. The ideal listening location is at the apex of an angle of 40° between the two systems. The distance between the enclosures should be determined by their distance from the listener and by this 40° listening angle.

PLACEMENT AND ADJUSTMENT

Adjust the individual level controls of each system while playing typical program material with the preamplifier or receiver tone controls set for flat response.

CARE OF FINISH
AND GRILLE

An oil finish requires occasional re-oiling. Follow the procedure listed under Finishing the Enclosure, omitting the sanding. For a lacquer or varnish finish, follow the manufacturer's recommendations.

The grille cloth can be cleaned by gently dusting it with a vacuum cleaner. Stains may be removed by using aerosol cleaners such as *Texize K2r*, *Goddard's Dry Clean*, or *Pen Champ Quick 'n Easy*, according to the manufacturer's directions.

WARNING: The use of cleaning fluids or other solvents will result in permanent discoloration of the grille fabric.

SERVICE

Should a component of your JBL Loudspeaker Component Series system require service, consult with your JBL dealer or write directly to the JBL Customer Service Department, describing the problem as fully as possible. Components returned for service must be sent prepaid to JBL Customer Service Department, 8500 Balboa Boulevard, Northridge, California 91329 U.S.A.

FOR ADDITIONAL
INFORMATION

If you have difficulty in achieving the fine performance which your JBL Loudspeaker Component Series system can provide, write directly to the JBL Technical Services Department, explaining the difficulty in detail.

RECOMMENDED SYSTEMS

SYSTEM NUMBER	TRANSDUCER MODEL NUMBERS	CROSSOVER NETWORK(S)
EN3P 85-litre (3 cubic foot) Enclosure		
S11	LE10A (LE14A), LE20	LX11 (LX8)
S21	124A (LE14A), LE5-2, 077	LX30
EN5C 140-litre (5 cubic foot) Enclosure		
S200B	136A, LE85/HL91	LX200B
S300	136A, LE85/HL92, 077	LX300
S22	136A, 375/HL93 (LE85/HL92), 077	LX80A, N7000 (N8000)
S7-1 ³	LE15A, LE85/HL92, (077)	LX13, (N8000)
S8-1 ³	LE15A, 375/HL93, 077	LX5, N7000
EN8P or EN8C (Specify) 225-litre (8 cubic foot) Enclosure		
S7-1 ³	LE15A, LE85/HL92, (077)	LX13, (N8000)
S8-1 ³	LE15A, 375/HL93, 077	LX5, N7000
S23	130A, 375/HL89, 075	LX50A, N7000
S24	130A, 375/HL90, 075	LX50A, N7000
S25	130A, 375/HL88, 075	LX50A, N7000
Components in parentheses represent optional additions or variations available on request.		

1. Model numbers GR3P; GR5C (GR5P optional); GR8P; GR8C.

2. Model numbers BF3, BF5, and BF8.

3. S7-1 and S8-1 systems are compatible with either the 140-litre or the 225-litre enclosure.



James B. Lansing Sound, Inc., 8500 Balboa Boulevard, Northridge, California 91329 U.S.A.

58493

IME/7-78

Printed in U.S.A.